

ROUTE 22q

QUINCY MALL

OUTBOUND From City Center Station To Quincy Mall

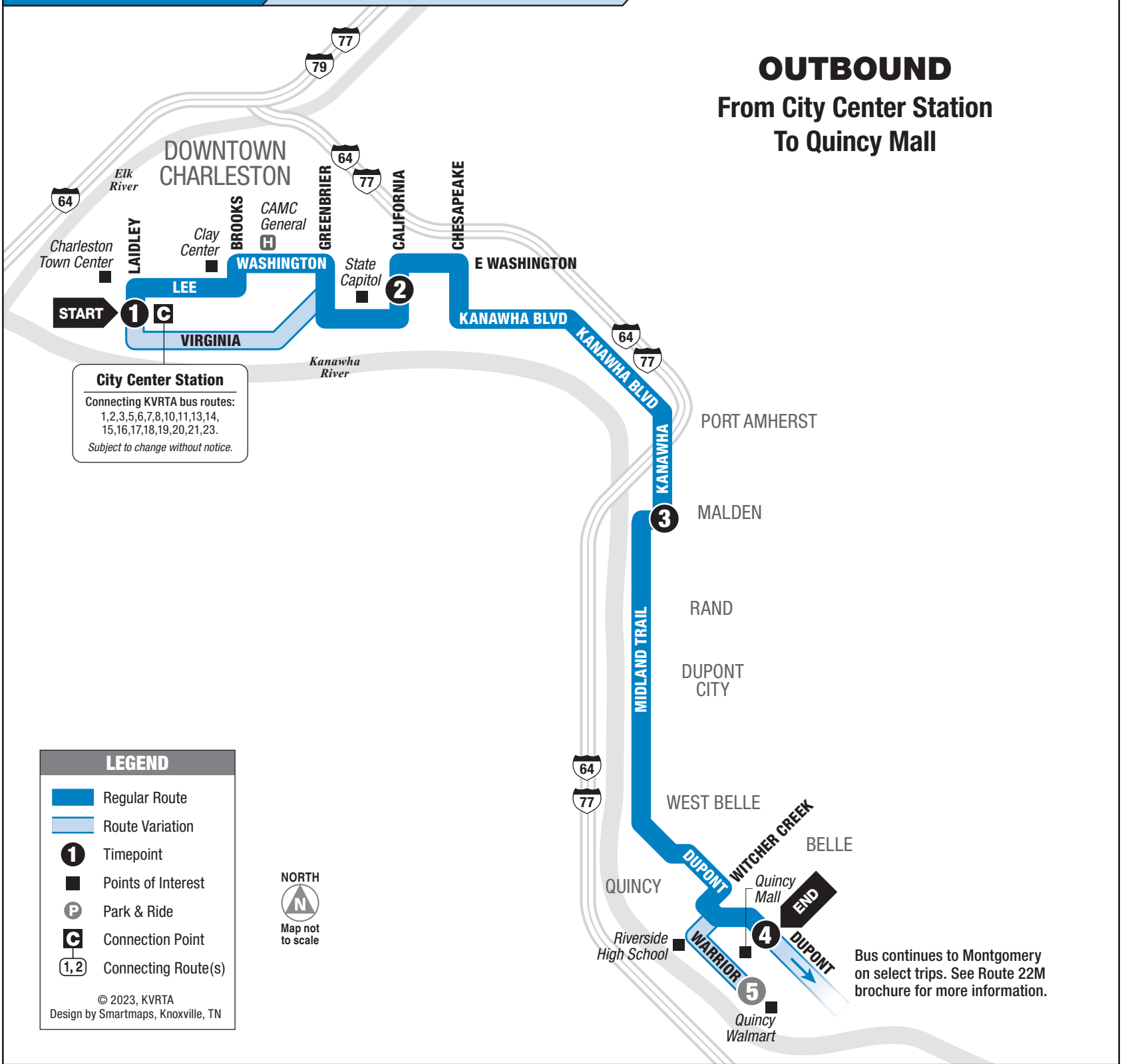

City Center Station
Connecting KVRTA bus routes:
1,2,3,5,6,7,8,10,11,13,14,
15,16,17,18,19,20,21,23.
Subject to change without notice.

LEGEND

- Regular Route
- Route Variation
- Timepoint
- Points of Interest
- Park & Ride
- Connection Point
- Connecting Route(s)

© 2023, KVRTA
Design by Smartmaps, Knoxville, TN

Bus continues to Montgomery on select trips. See Route 22M brochure for more information.

MONDAY – SATURDAY • OUTBOUND FROM CITY CENTER STATION TO QUINCY MALL

	1 City Center Station	2 Capitol Complex	3 Malden Underpass	4 Quincy Mall	5 Quincy Walmart
AM	4:15	4:27	4:37	4:55	—
AM	5:15	5:27	5:37	5:55	—
AM	6:15	6:27	6:37	6:55	—
AM	6:45	6:57	7:07	7:25	7:30
AM	7:45	7:57	8:07	8:25	8:30
AM	8:15	8:27	8:37	8:55	—
AM	8:45	8:57	9:07	9:25	9:30
AM	9:15	9:27	9:37	9:55	—
AM	10:15	10:27	10:37	10:55	—
AM	10:45	10:57	11:07	11:25	11:30
AM	11:45	11:57	12:07	12:25	12:30
AM	12:15	12:27	12:37	12:55	—
AM	12:45	12:57	1:07	1:25	1:30
AM	2:15	2:27	2:37	2:55	—
AM	3:15	3:27	3:37	3:55	4:00
PM	4:15	4:27	4:37	4:55	—
PM	4:45	4:57	5:07	5:25	5:30
PM	5:15	5:27	5:37	5:55	—
PM	6:15	6:27	6:37	6:55	—
PM	7:15	7:27	7:37	7:55	8:00
PM	9:20	9:31	9:41	9:55	—
PM	11:15	11:24	11:33	11:48	11:51

SUNDAY • OUTBOUND FROM CITY CENTER STATION TO QUINCY MALL

	1 City Center Station	2 Capitol Complex	3 Malden Underpass	5 Quincy Walmart	4 Quincy Mall
AM	4:25	4:35	4:45	4:57	5:00
AM	6:30	6:41	6:49	7:05	—
AM	8:40	8:52	9:00	9:20	9:23
AM	10:30	10:42	10:52	—	11:07
AM	12:00	12:12	12:22	12:42	12:45
AM	2:15	2:27	2:36	—	2:50
PM	5:25	5:33	5:42	5:53	5:56
PM	7:15	7:24	7:32	7:47	7:50
PM	9:15	9:24	9:35	—	9:50
PM	11:15	11:24	11:32	—	11:47

All Sunday trips travel via Virginia Street from Transit Mall.

Shaded trips continue to Montgomery and do not serve the Quincy Walmart. See Route 22M for map and schedule.

Unshaded trips drop off and end at Quincy Mall Walmart.

See other side for trips TO Downtown Charleston

Please have your fare ready before boarding the bus.

INFORMATION

No smoking, no pets, no food or open beverages, no playing audio devices.

For safety's sake, please be seated after boarding the bus and remain seated at all times. After ringing the bell for your destination, stay seated until the bus comes to a complete stop. When boarding or exiting the bus, use extreme caution on steps and around the doors. Do not attempt to cross the street in front of the bus after exiting and wait for traffic to clear before crossing. Shirts and shoes must be worn while riding the bus. Litter receptacles are located at the front of the bus. Please help us keep our buses clean!

Senior Citizens and handicapped individuals with proper I.D. or those who present a valid Medicare Card may ride any KVRTA bus (except commuter buses) for 1/2 fare. Contact KVRTA for details at 343-7586.

Notice of Title VI Rights
It is a KVRTA policy that we do not discriminate based on race, gender, color or national origin. Any inquiries or complaints related to Title VI may be sent in writing to the General Manager, P.O. Box 1188, Charleston, WV 25324 or calling 304-343-3840. A downloadable form is available on KVRTA website www.rideonkrt.com

INSTRUCTIONS

- 1** The bus stops at this location at listed times. Look for the column of times below the matching symbol in the schedule.
- Only certain trips operate along this portion of the route. See the schedule for trips that provide service here.
- G** **1,2,3** Connection point. Shows where this bus intersects with connecting routes.
- The bus stops at the times listed below the numbered symbol. Light times are A.M.; bold times are P.M.
- The timetable shows when the bus stops. Actual times may vary and depend upon traffic and weather conditions.

1	2	3	4
9:00	9:15	9:40	10:00
10:00	—	10:40	11:00
11:00	11:15	11:40	12:00
12:00	—	12:40	1:00
1:00	1:15	1:40	2:00

For more information call: 343-7586 • www.rideonkrt.com

ROUTE 22Q

QUINCY MALL

Bus originates from Montgomery on select trips. See Route 22M brochure for more information.

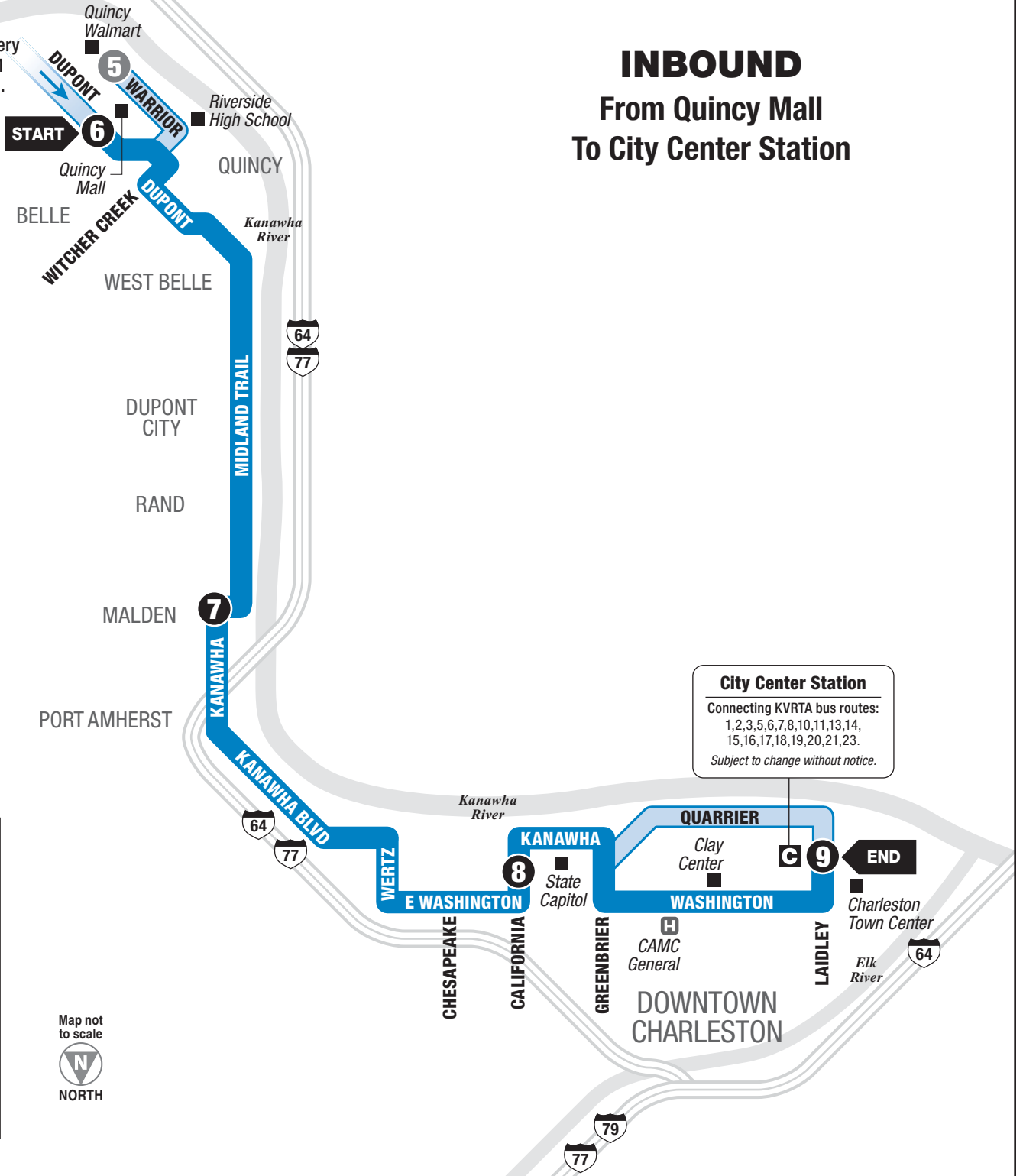

INBOUND From Quincy Mall To City Center Station

City Center Station
Connecting KVRTA bus routes:
1,2,3,5,6,7,8,10,11,13,14,
15,16,17,18,19,20,21,23.
Subject to change without notice.

LEGEND

- Regular Route
- Route Variation
- Timepoint
- Points of Interest
- Park & Ride
- Connection Point
- Connecting Route(s)

© 2023, KVRTA
Design by Smartmaps, Knoxville, TN

MONDAY – SATURDAY • INBOUND FROM QUINCY MALL TO CITY CENTER STATION

	5 Quincy Walmart	6 Quincy Mall	7 Malden Underpass	8 Capitol Complex	9 City Center Station
	—	6:00	6:20	6:33	6:45
	—	7:00	7:20	7:33	7:45
	7:33	—	7:51	8:01	8:15
	—	8:00	8:20	8:33	8:45
AM	8:33	—	8:51	9:01	9:15
	9:33	—	9:51	10:01	10:15
	—	10:00	10:22	10:32	10:45
	—	11:00	11:22	11:32	11:45
	11:33	—	11:51	12:01	12:15
	—	12:00	12:22	12:32	12:45
	12:33	—	12:51	1:01	1:15
	1:33	—	1:51	2:01	2:15
	—	2:00	2:22	2:32	2:45
	4:28	—	4:46	4:56	5:10
	—	4:00	4:22	4:32	4:45
PM	5:33	—	5:51	6:01	6:15
	—	6:00	6:22	6:32	6:45
	—	7:00	7:22	7:32	7:45
	8:28	—	8:46	8:56	9:10
	—	8:10	8:32	8:42	8:55
	—	10:35	10:52	11:02	11:15
	11:54	—	12:09	12:17	12:29

SUNDAY • INBOUND FROM QUINCY MALL TO CITY CENTER STATION

	6 Quincy Mall	5 Quincy Walmart	7 Malden Underpass	8 Capitol Complex	9 City Center Station
	5:42	5:45	6:05	6:12	6:30
	—	7:17	7:42	7:52	8:10
AM	10:25	10:28	10:45	10:55	11:10
	11:17	11:23	11:38	11:47	12:00
	1:50	1:53	2:08	2:16	2:30
	2:50	2:55	3:08	3:16	3:30
PM	6:40	6:43	6:55	7:02	7:15
	8:35	8:38	8:52	8:59	9:15
	10:25	10:33	10:51	11:00	11:15
	11:50	11:58	12:13	12:23	12:35

All Sunday trips travel via Quarrier Street to Transit Mall.

Shaded trips come from Montgomery and do not serve the Quincy Walmart. See Route 22M for map and schedule.

Unshaded trips begin at the Quincy Walmart, and do not always serve Quincy Mall.

See other side for trips FROM Downtown Charleston

Effective
3.2023

304-343-7586

RIDEONKRT.COM

Quincy Mall

SERVING:

- Clay Center
- CAMC General Division
- Capitol Complex
- Malden / Rand
- Dupont City
- Town of Belle
- Quincy Mall / Walmart

ROUTE 22Q

DAILY SERVICE

KANAWHA VALLEY REGIONAL
TRANSPORTATION AUTHORITY